

- Notes:
1. Tolerance is ±0.3mm unless otherwise noted.
 2. Marked with * is important dimension.
 3. Marked with () is reference dimension.

<p>SHANTOU GOWORLD DISPLAY CO., LTD. Tel: 0754-88192283 Fax: 0754-86339619</p>		<p>DRAWN: 余冰洁 2020.04.21</p>	<p>CHECKED: 陈秀丹 2020.04.21</p>	<p>APPROVED: 黄宏生 2020.04.21</p>	<p>LCM NO: GWMDD16800-LCM/A DWG NO: ED-16800-LCM/A</p>	<p>Rev: 01 SHEET 1 OF 3</p>	<p>UNITS: mm</p>
<p>CUSTOMER APPROVAL:</p> <p>This drawing contains confidential information and is the property of GOWORLD, without whose permission it may not be copied, shown or handed to a third party or otherwise used.</p>							

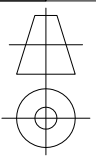

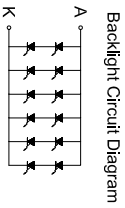
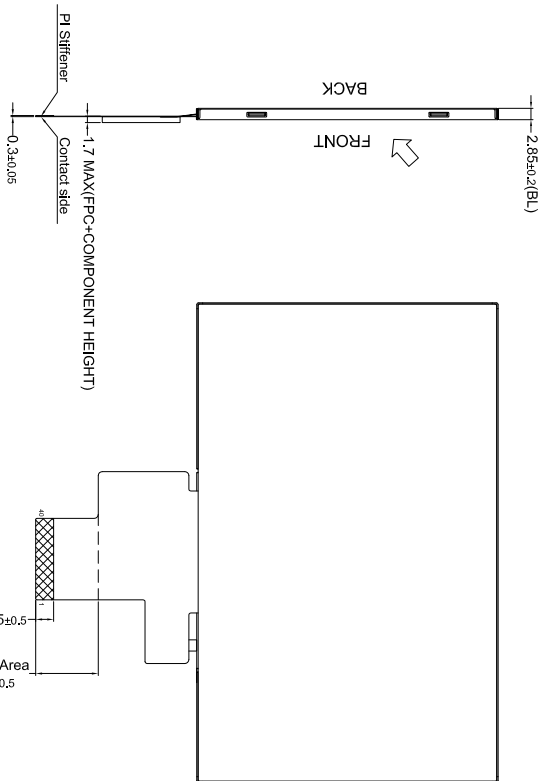
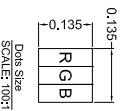
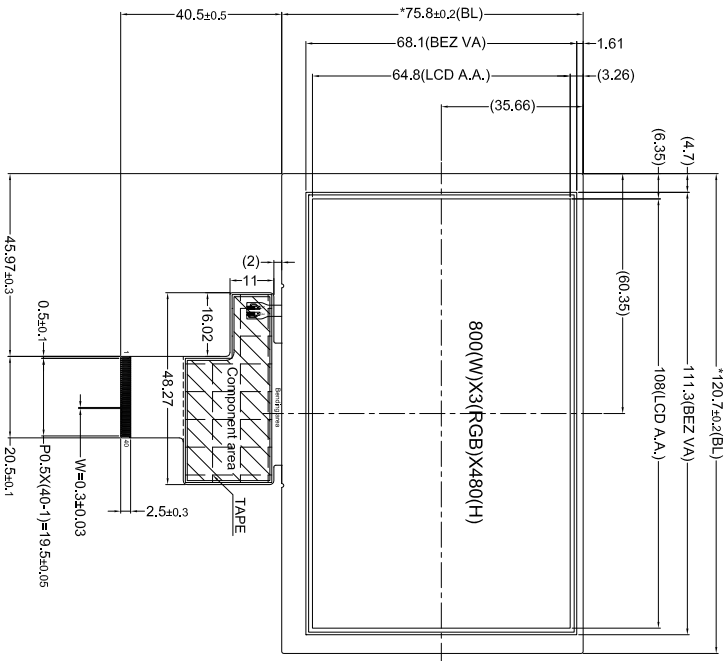

WHITE LED (6*2pcs)
Constant Current Driving, I=120mA
V=6.2±0.6V @I=120mA

- Notes:
1. Tolerance is ± 0.3 mm unless otherwise noted.
 2. Marked with * is important dimension.
 3. Marked with () is reference dimension.



SHANTOU GOWORLD DISPLAY CO., LTD.
Tel:0754-88192283 Fax:0754-88339619

DRAWN:

余冰洁

2020.04.21

CHECKED:

陈秀丹

2020.04.21

APPROVED:

黄宏生

2020.04.21

LCM NO: GWMDD16800-LCM/A

DWG NO: ED-16800-LCM/A

Rev: 01

UNITS: mm

SHEET 2 OF 3

CUSTOMER APPROVAL:

This drawing contains confidential information and is the property of GOWORLD, without whose permission it may not be copied, shown or handed to a third party or otherwise used.

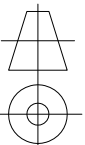



Front View

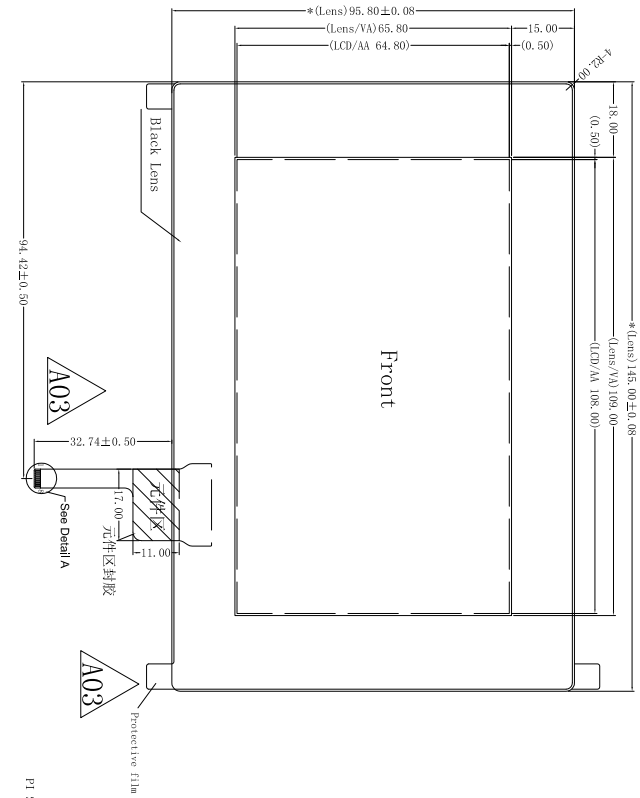

Back View

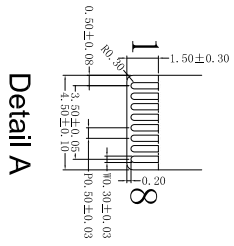
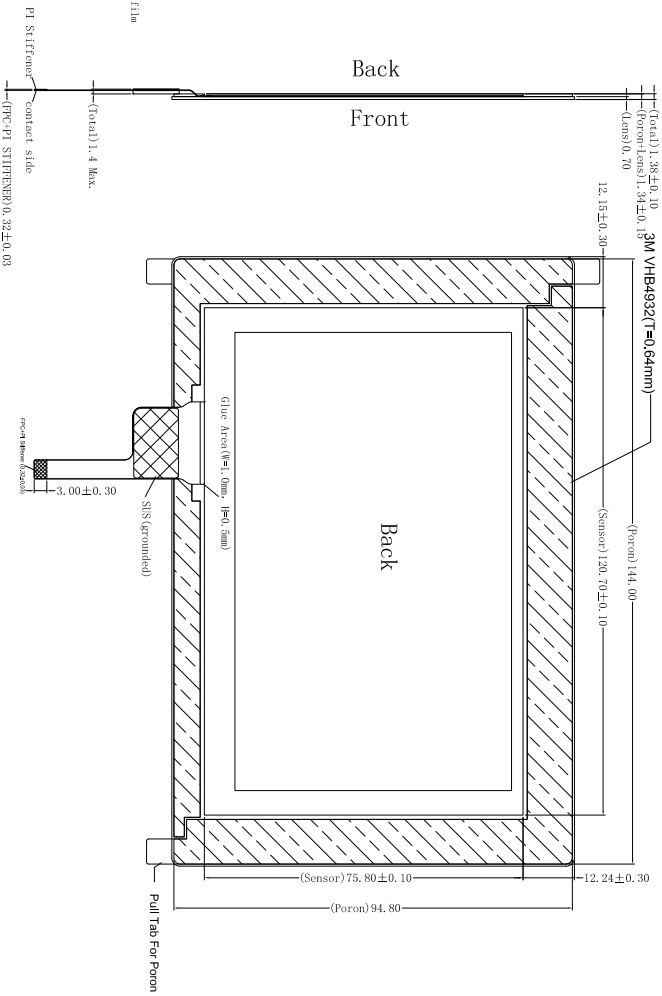

Detail A

CIP PIN ASSIGNMENT

PIN NO.	FUNCTION
1	GND
2	INT
3	RESET
4	SGA
5	SCL
6	VDD
7	GND
8	GND

Note:
 IC: Tango C48
 VDD=3.3V±0.1V, IOWDD=3.3V±0.1V
 Operating temp.: -20° ~ +70° C
 Storage temp.: -30° ~ +80° C
 Dimensions with () are for reference
 General tolerance: ±0.30mm



SHANTOU GOWORLD DISPLAY CO., LTD.
 Tel: 0754-88192283 Fax: 0754-86339619

DRAWN: 陈佳婷 周晓峰
 2019-05-09

CHECKED: 游荣鑫
 2019-05-09

APPROVED: 郑清交
 2019-05-09

LCM NO: GHTC15884-CTPM/A	Rev: 03	UNITS: mm
DWG NO: ED-15884-CTPM/A	SHEET 1 OF 1	
A03: Modify the handle of protective film, the position tolerance of FPC and the temperature range.		
A02: Modify the thickness of FPC contact side.		
A01: Modify the IC, the poron and the dimensions. Delete DST.		
A00: Original Version.		

CUSTOMER APPROVAL:

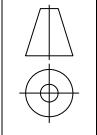



Front View

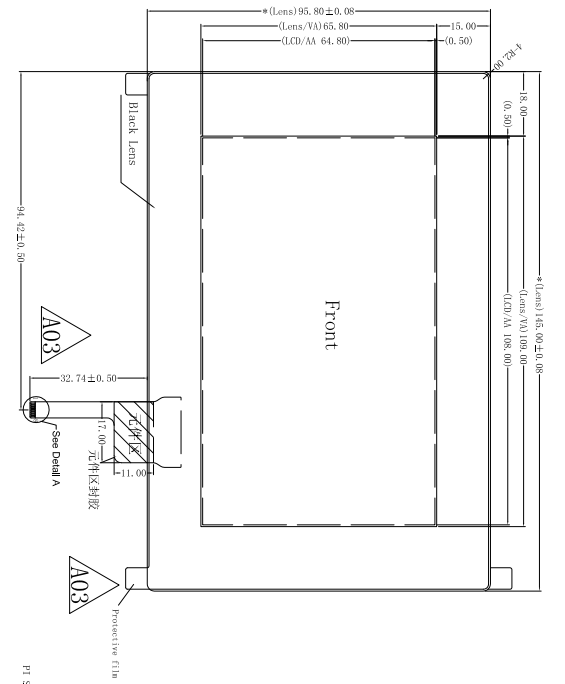

Back View

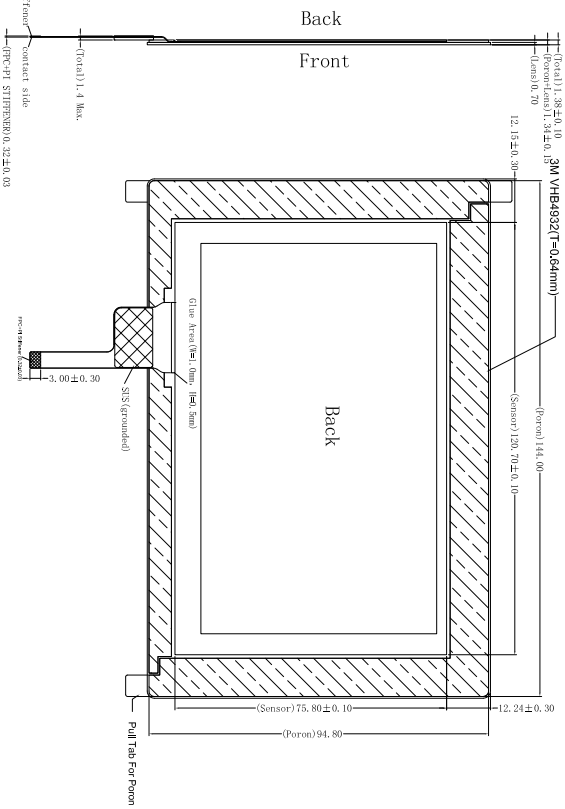

Note:
 IC: Tango C48
 VDD=3, 3V±0.1V, 10VDD=3, 3V±0.1V
 Operating temp.: -20° ~ +70° C
 Storage temp.: -30° ~ +80° C
 Dimensions with () are for reference
 Dimensions with * are pivotal
 General tolerance: ±0.30mm

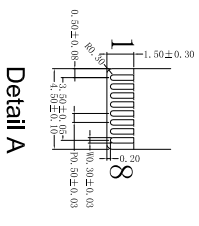

GTP PIN ASSIGNMENT	
PIN NO.	FUNCTION
1	SW0
2	INT
3	RESET
4	SMA
5	SCL
6	VDD
7	SW0
8	SW0

A03: Modify the handle of protective film, the position tolerance of PFC and the temperature range.
 A02: Modify the thickness of PFC contact side.
 A01: Modify the IC, the pore and the dimensions. Delete DST

A00: Original Version.

CUSTOMER APPROVAL:



SHANTOU GOMORLD DISPLAY CO., LTD.
 Tel: 0754-88192283 Fax: 0754-86339619

DRAWN: 陈佳婷 周晓峰
 2019-05-09

CHECKED: 游崇鑫
 2019-05-09

APPROVED: 郑清交
 2019-05-09

LCM NO: GWTC15884-CTPM/A

Rev: 03

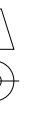

DWG NO: EJ-15884-CTPM/A

SHEET 1 OF 1

