

NO	Part Name	Quantity
6	BEZ	1
5	Pull Tape	1
4	Backlight	1
3	FPC	1
2	IC	1
1	LCD	1

CUSTOMER APPROVAL:

This drawing contains confidential information and is the property of GOWORLD, without whose permission it may not be copied, shown or handed to a third party or otherwise used.



SHANTOU GOWORLD DISPLAY CO., LTD

Tel: 0754-88192283 Fax: 0754-86339619

DRAWN: 熊明星  
2017-06-02

CHECKED: 陈秀丹  
2017-06-02

APPROVED: 江树仁  
2017-06-02

LCM NO: GWMTF14812-LCM/A

Rev: 01

UNITS: mm

DWG NO: ED-14812-LCM/A

SHEET 2 of 3

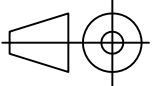



Block Diagram

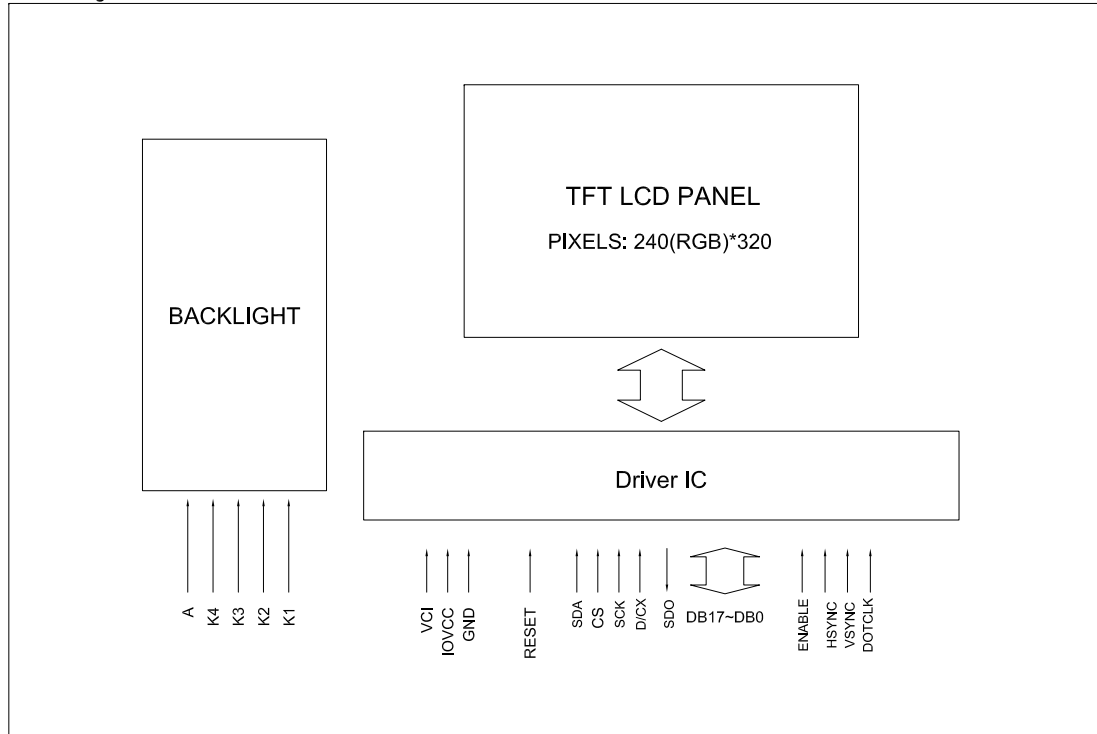

Pin Description: 4-line serial interface

PIN	Symbol	Function Description
1	GND	Power Ground
2	VCI	Analog power supply
3	GND	Power Ground
4	IOVCC	Digital IO Pad power supply
5	ENABLE	Data enable signal for RGB Interface
6	HSYNC	Line synchronizing signal for RGB Interface
7	VSYNC	Frame synchronizing signal for RGB Interface
8	DOTCLK	Dot clock signal for RGB Interface
9	GND	Power Ground
10	DB0	8/18-bit parallel bi-directional data bus for register and GRAM if not used, please connect to GND or open
11	DB1	
12	DB2	
13	DB3	
14	DB4	
15	DB5	
16	DB6	
17	DB7	
18	DB8	
19	DB9	
20	DB10	
21	DB11	
22	DB12	
23	DB13	
24	DB14	
25	DB15	
26	DB16	
27	DB17	
28	RESET	Reset signal Input pin (low active)
29	GND	Power Ground
30	CS	Chip select signal Input pin (low active)
31	SDA	Serial data pin
32	SDO	SPI interface output pin
33	SCK	Serial interface clock
34	A	Backlight anode (positive)
35	K4	Backlight cathode 1 (negative)
36	K3	Backlight cathode 2 (negative)
37	K2	Backlight cathode 3 (negative)
38	K1	Backlight cathode 4 (negative)
39	GND	Power Ground
40	D/CX	Display data/command selection pin

DISPLAY TYPE: TFT/Normal White (65K/262K Color)  
 DISPLAY MODE: Transmissive  
 DRIVER IC: ST7789V  
 POWER VOLTAGE: IOVCC=2.8~3.3V, VCI=2.8~3.3V  
 BACKLIGHT COLOR: White LED(4-LED parallel)  
 Higher Luminance LEDs  
 $V_{led}=3.0\pm 0.3V$ ,  $I_{led}(TYP.)=4*18mA=72mA$   
 OPERATING TEMPRATURE:  $-10^{\circ} \sim +65^{\circ}C$   
 STORAGE TEMPRATURE:  $-20^{\circ} \sim +80^{\circ}C$   
 INTERFACE CONNECTOR: FPC  
 All UNMARKED TOLERANCE:  $\pm 0.3mm$   
 ( ) REFERENCE DIMENSION

IMS	IM2	IM1	IM0	MPU Interface Mode
1	1	1	0	4-line 8bit serial I/F II

A01: 调整背光电电压范围  
 A00: Original Version  
 Revision History:

CUSTOMER APPROVAL:

This drawing contains confidential information and is the property of GOWORLD, without whose permission it may not be copied, shown or handed to a third party or otherwise used.



SHANTOU GOWORLD DISPLAY CO., LTD.

Tel: 0754-88192283 Fax: 0754-86339619

DRAWN: 翁沛根  
 2017-06-02

CHECKED: 江树仁  
 2017-06-02

APPROVED: 江树仁  
 2017-06-02

LCM NO: GWMTF14812-LCM/A

Rev: 01

UNITS: mm

DWG NO: ED-14812-LCM/A

SHEET 3 of 3

